

1. Getting started:

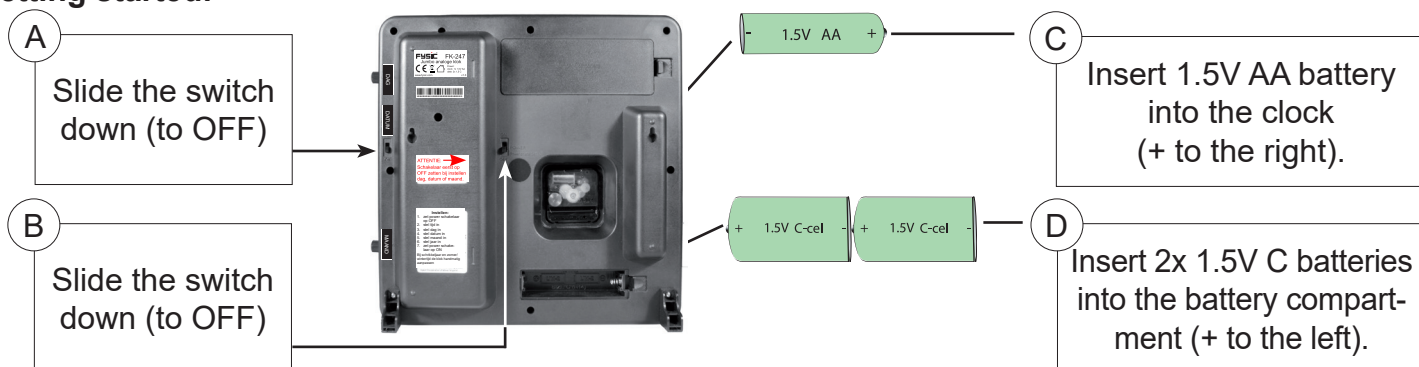

2. Time setup:

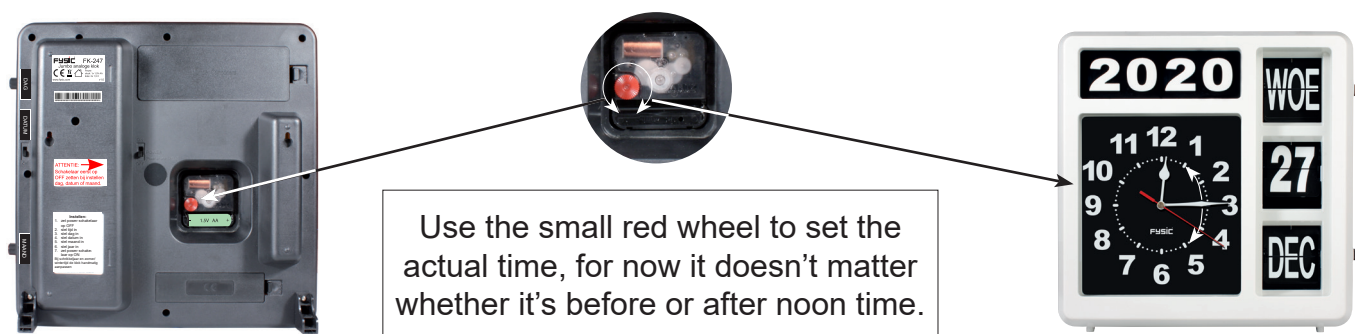

3. Day setup:

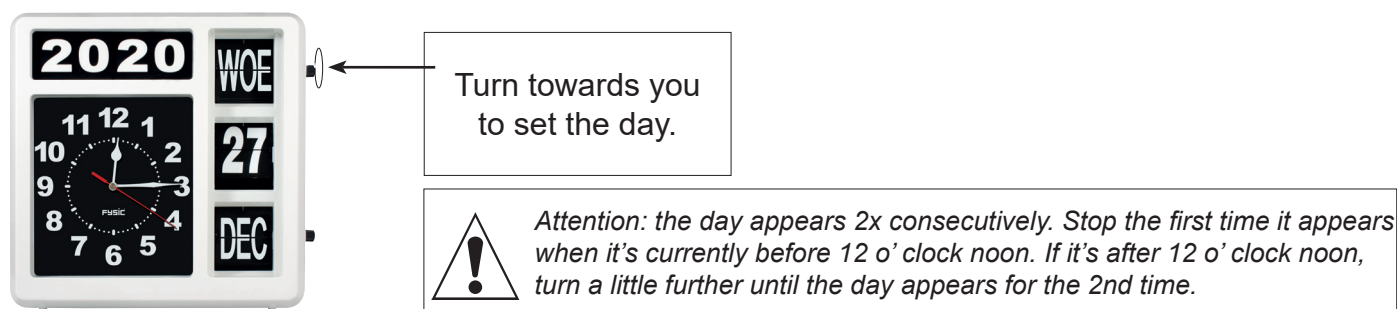

4. Date setup:

Slide the switch up in case the date must be set.

You'll hear a small engine running and the date display will change.

Slide the switch down when the correct date is displayed.



5. Month setup:



Turn towards you
to set the month.

6. Year setup:



Behind the cover, you'll find a small
pouch with loose numbers. You can use
these to easily set the correct year.



7. Start the clock:



Slide the switch up (ON)
to turn on the clock.

Tips & remarks:

- The clock is suitable as both a desk model and a wall model. The rear of the clock is provided with key holes to attach it to the wall.
- Please keep in mind this clock doesn't show daylight saving time nor does it keep track of leap years. In this case, you'll need to manually adjust the time/date.
- When setting the time, you must set the POWER switch to OFF to prevent the date from possibly jumping a day too far.
- However, the clock does keep track of the amount of days each month has.
- The clock is only suitable for indoor use.
- Only clean the clock with a moist cloth. Never use any cleaning agents.



wall-mounting



Service		WWW.FYSIC.COM SERVICE@FYSIC.NL	FYSIC
		NL 073 6411 355 (Lokaal tarief)	
		BE 03 238 5666 (Lokaal tarief)	
		DE 0180 503 0085 (Lokale Festnetzkosten)	
Help		Hesdo, Australiëlaan 1, 5232 BB, 's-Hertogenbosch, The Netherlands	

Do not discard exhausted batteries, but bring them to your local depot for small chemical waste.

When this product has reached the end of its lifespan, it must not be discarded as regular domestic waste; you're obliged to take it to a collection point for the recycling of electric en electronic device.

