



# USER'S MANUAL

## BT-210 Light

**Bluetooth Stereo Speaker With Clock AUX Input  
Smart LED Light**



For more information: [www.lenco.com](http://www.lenco.com)

## A. Warning

### Don'ts

- Do not place naked flames, such as lighted candles on or near the product.
- Do not place objects filled with liquids, such as vases on or near the product.
- Do not use or store this product in a place where it is subject to direct sunlight, heat, excessive dust or vibration.
- Do not keep or store this product in wet conditions for long period.
- Do not clean this product with water or other liquids.
- Do not block or cover the slots and holes in the product.
- Do not push foreign objects into the slots or holes in the product.
- Do not attempt to open this product yourself. There are no user serviceable parts inside.
- Do not allow children access to plastic bags.

### Safety Instructions

Before using this product, read and follow all warnings and instructions.

- This product is not intended for use by young children. Young children should be properly supervised.
- This product is intended for household use only and not for commercial or industrial use.
- Do not expose to dripping or splashing.
- No naked flame sources, such as lighted candles, should be placed on the product.
- Ventilation should not be impeded by covering ventilation openings with items such as newspapers, table cloths, curtains and the like.
- Make sure the unit is adjusted to a stable position. Damage caused by using this product in an unstable position or by failure to follow any other warning or precaution contained within this user manual will not be covered by warranty.



### Warning

- Never remove the casing of this apparatus.
- Never place this apparatus on the other electrical equipment.

### Notice

- If at any time in the future you should need to dispose of this product please note that: All batteries and accumulators need to be removed

from this product (Removal of Waste Batteries and Accumulators).

- Always bring your product to a professional to remove the built-in battery.

**B. Outlook and Controls**

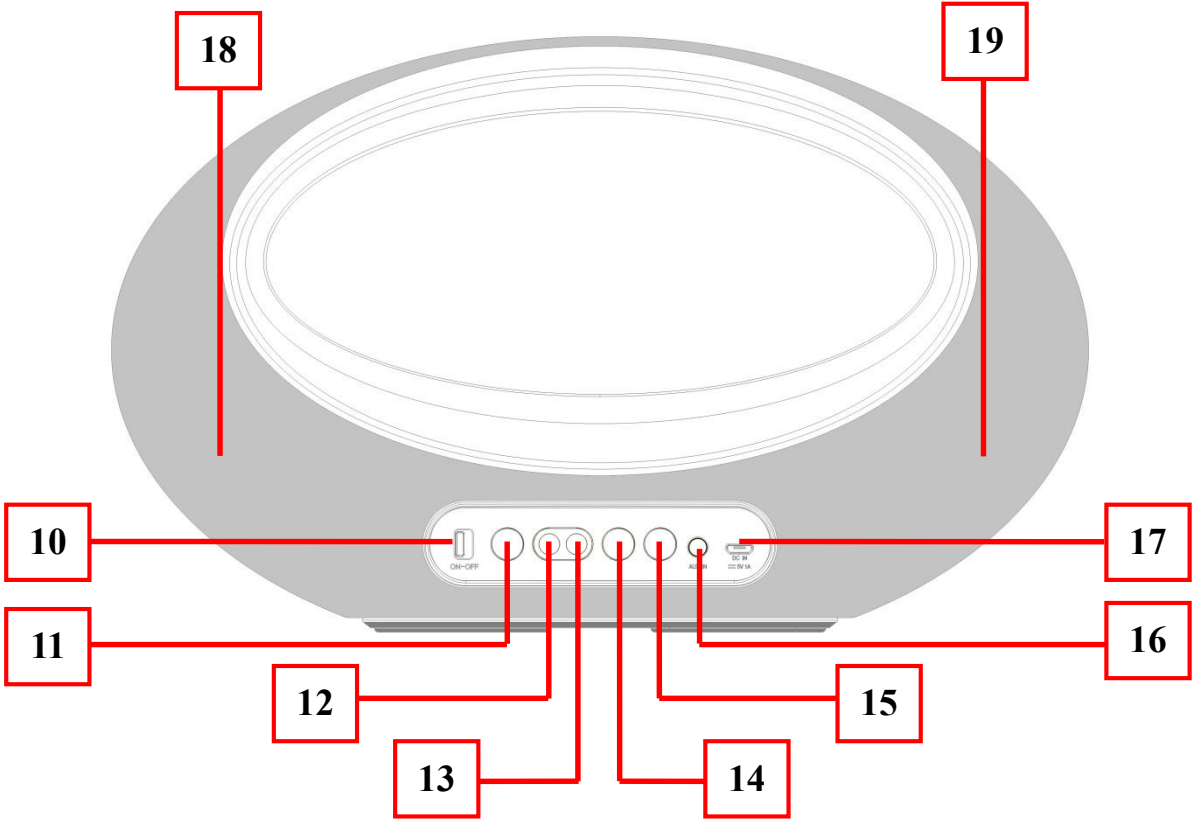
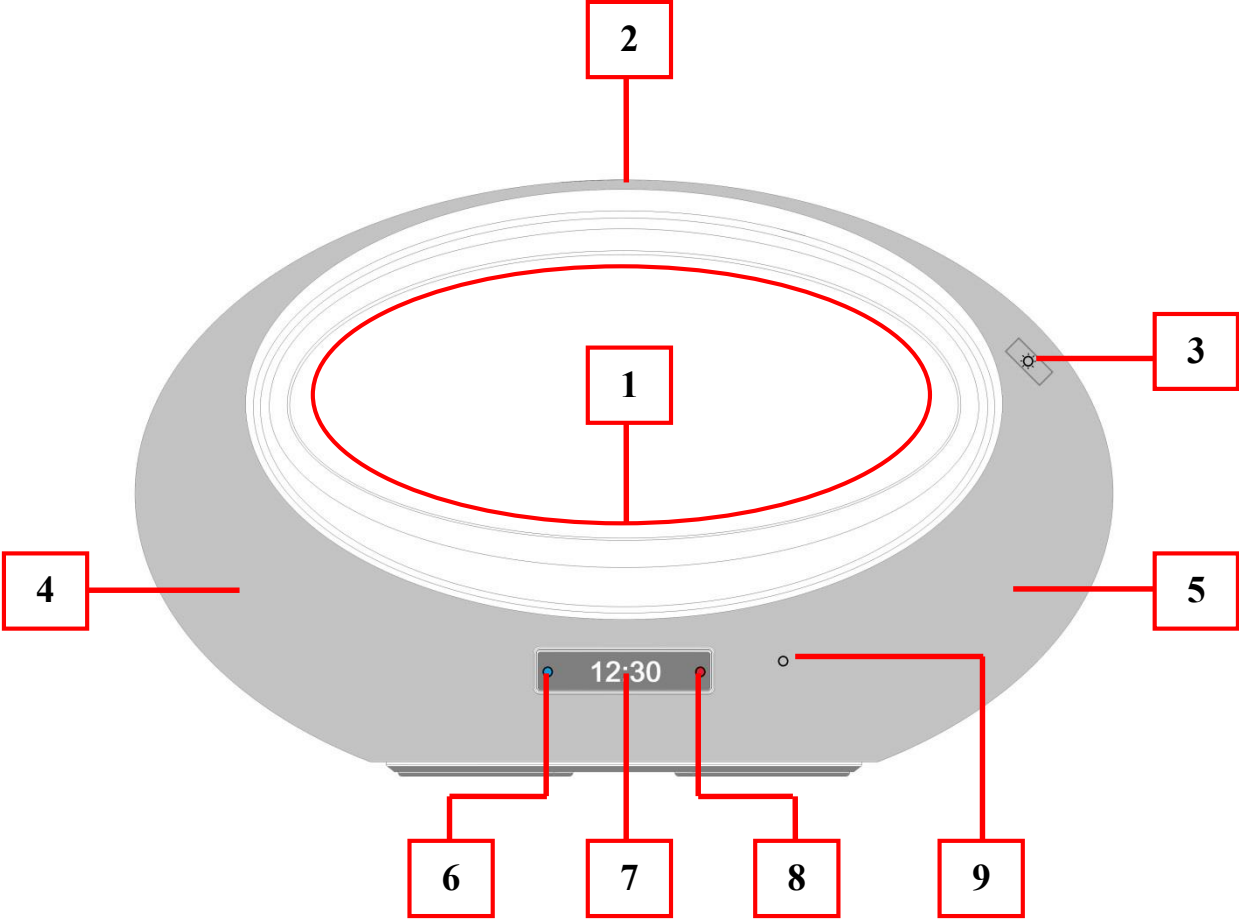

Item	Description
	<b>Light Tower</b>
	<b>Handle</b>
	<b>○ Touch Sensor</b> (Display Clock, light bright/Dim/Off, RGB light)
	<b>Left Speaker</b>
	<b>Right Speaker</b>
	<b>Bluetooth LED</b> (Blue, Red for AUX)
	<b>Clock Time Display</b> (White LED Segments)
	<b>Charge LED</b> (Red, Green)
	<b>MIC Hole Position</b>
	<b>Power ON/OFF</b> (Slide Switch)
	<b>✱/Stand-by Button</b> (Bluetooth On/Off, Pairing)
	<b>+ Button</b> (Volume up, Next track)
	<b>— Button</b> (Volume down, Previous track)
	<b>⏮/▶⏭ Button</b> (Play/Pause, new searching, Pick up/Hang up call/Last dialed)
	<b>☀ Light Mode</b> (Night light/Rainbow/R-G-B Effect)
	<b>AUX IN Jack</b> (3.5mm Jack, Stereo)
	<b>Micro USB socket</b> (DC Input: DC 5V 1A, Service)
	<b>Right Bass Radiator</b>
	<b>Left Bass Radiator</b>

### C. About the rechargeable Battery

This Bluetooth Speaker has an internal, non-user-replaceable battery. For best results, the first time you use this Bluetooth Speaker, let it charge for about 5 ~ 6 hours or until the Charging LED indicator light from red to green which show you the battery is fully charged.

For maintain the battery life and performance, if speaker isn't used for a while, the battery might need to be recharged. Charge the battery at least once per month.

#### 1. To charge the rechargeable battery:

- Connect the Bluetooth Speaker's "**Micro USB socket (17)**" with the USB power charger (not included) which able to provides output at least DC 5V 1A for charge connection via the USB cable. Or,
- Connect the Bluetooth Speaker's "**Micro USB socket (17)**" with the Computer's USB port which is USB 3.0 standard.
- The "**Charge LED (8)**" will turn On in red, the battery is in charging.
- The "**Charge LED (8)**" will turn green from red when the rechargeable battery is fully charged.

- e. Disconnect the USB cable when it is done.

**Important:** Only use charge function if you connected the Bluetooth Speaker to USB 2.0 port of the computer. (It needs longer time to charge the battery fully)

The Bluetooth Speaker may works unstable if you use USB 2.0 port of computer for charging and music playing function together. Use USB 3.0 port to instead in this case.

#### **D. Power ON/OFF (Time Clock Display & Light mode)**

##### **1. To Power ON the device:**



- a. Slide the “**Power ON/OFF (10)**” switch to “**ON**” position, the “**Clock Time Display (7)**” will show and the “**Light Tower (1)**” will light on from red and changing color for 6 ~ 7 seconds.
- b. This shows you that the device is in clock time display and light mode.
- c. At this Power ON mode, the Bluetooth function is in stand-by off. Press and hold the /Stand-by (11) button to turn On the Bluetooth function if you wish. (See item E.1.a~g)

**Note:** when first time you use this device, the clock time may not show correctly, please do the time sync with your mobile device by using Bluetooth pairing to set the clock time.

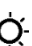
##### **2. Use light mode and display clock time:**

- a. Move your hand to tap once the “**○ Touch sensor (3)**” to turn the night light on in white when you want it.
- b. At the same time, the clock time will display for 1 minute for you view when each time you tap the “**○ Touch sensor (3)**”.
- c. Tap again the “**○ Touch sensor (3)**” will dim the night light level and again to turn off the night light from dim. Moreover, the clock time display will off when every time the night light is switched to off.
- d. It repeatedly functions from light “**Bright**” > “**Dim**” > “**OFF**” if you continue make tap on “ **Touch sensor (3)**”.

##### **3. To select light mode: (Night light, Rainbow, Normal R-G-B)**

- a. In light up mode, you can select light effect “**Night light/Rainbow/Normal R-G-B**” effect as you’re desired by press or pressing the “ **Light Mode (15)**” button.
- b. When light tower is displaying white light it is in night light mode, you can switch light to “**Dim**” > “**Off**” > “**Bright**” repeatedly by using the tap or tapping the “ **Touch sensor (3)**”.
- c. When the “**Rainbow**” effect is selected, the light tower will displaying light color follow in rainbow style sequentially. (The “ **Touch sensor**

(3)” function is disabled when selected this light effect)

- d. When **“Normal R-G-B”** effect is selected, the light tower will displaying light in light **red** (system default), however you can select your favor color which to display by using the “☼ **Touch sensor (3)**”.
- e. To turn off the smart LED light at any light mode, press and hold the “☼ **Light Mode (15)**” button

#### **4. To Power OFF the device:**

- a. If you not to using the device for a while, slide the **“Power ON/OFF (10)”** switch to **“OFF”** position.
- b. This will help to saving the battery energy and extend the rechargeable battery life.

### **E. Use Bluetooth Function**

#### **1. Turn On Bluetooth function and Pairing**

- a. In power at on and clock time display and light mode;
- b. Press and hold the “☼/Stand-by (11)” button to turn on the Bluetooth function, a series of tones will sound and the **“Bluetooth LED (7)”** will rapidly flash blue in seconds;
- c. The Bluetooth is in pairing mode and waiting for pair. At the same time, the RGB music lights will turn on in **red**.
- d. Then, activate the Bluetooth function in your Bluetooth device (such as Mobile Phone or Personal Computer); the device will enter to Bluetooth searching mode automatically, if not, tap the relate selection to manually enter to searching mode. (refer to your device’s manual when necessary)
- e. Your mobile device should show **“BT-210 LIGHT”** in Bluetooth Devices list, and then select it for pairing. Waiting for some seconds and you will see connected message as shown on your mobile device. (For some Bluetooth devices, you may need to input **“0000”** as pairing password)
- f. If pairing is successful, a series of tones will sound and the **“Bluetooth LED (6)”** will switch to slow blinking blue from fast.
- g. Now, you can start to music play from your mobile device by it music player program and enjoy the provided Bluetooth RGB music lights for bring a bit of fun.

#### **2. Bluetooth RGB Music light:**

- a. The Bluetooth RGB music lights function will turn on in **red** automatically when every time you use Bluetooth music function.
- b. And the Bluetooth RGB music lights will change colors follow the

rhythm of playing music.

- c. The Bluetooth RGB music lights function will disabled automatically when Bluetooth function is turned Off from the BT-210 Light.

### **3. Bluetooth Music Playing Controls (two way function)**

#### **On your Bluetooth Device:**

- a. Switch to music player menu and choose a music to start the play from playlist or by using “◀▶” button/icon. Play/Pause the playing music by using “▶/⏸” button/icon.
- b. To adjust the volume level by using the device’s volume control “**Down/Up**” button/icon on your Bluetooth device. (refer to your device user’s manual when necessary)

#### **On Bluetooth Speaker:**

- c. In playing music, press “⏸/▶ (14)” button to pause the playing music. Press it again to resume.
- d. Press and hold the “+ (11)” button to increases the volume level.
- e. Press and hold the “- (12)” button to decreases the volume level.
- f. When maximum or minimum volume is reached, a beep will sound.
- g. Press the “+ (11)” button to play next music file.
- h. Press the “- (12)” button to play previous music file.

### **4. Clock Time Sync & Display**

- a. The device is design allow the clock time sync automatically when each time you connect the device with your mobile by Bluetooth connection and open the mobile app of Lenco BT-210 LIGHT, which mean no time clock set is need on device. *(Please refer to item H below mentioned for detail)*
- b. To display the clock time, move your hand to tap the “☀ **Touch sensor (3)**”, the clock time will display for you view for 1 minute.

### **5. Turn Off Bluetooth function**

- a. To turn off the Bluetooth function, press and hold the “⌘/Stand-by (11)” button.
- b. The device will return to clock time display and light mode for waiting it functions.

**Note:** *For saving battery energy, the Bluetooth mode will turn off automatically when no device is reconnected or paired in 8 minutes. Turn it on again by press and hold the “⌘/Stand-by (11)” button when you want.*

### **6. Disconnect from paired device**

- a. To disconnect with paired device and for better result, turn Off the Bluetooth function by press and hold the “⌘/Stand-by (11)” button directly;



- b. Or, you can choose **“Disconnect”** from Bluetooth paired device list on your mobile device;
- c. In this case; the Bluetooth Speaker will switch back into **“Searching/Pairing”** mode automatically, a series of tones will sound and the **“Bluetooth LED (6)”** will rapidly flash blue again from slow blinking.
- d. Now, you can process for new mobile device pair or turn Off the Bluetooth function if you wanted.

## **7. Reconnect for paired device**

- a. Every time you turn On Bluetooth function from clock time display and light mode; it will firstly searching for the mobile device which has been paired previously and still in record;
- b. The Bluetooth function will reconnect this mobile device as priority if it is in Bluetooth searching device mode and in connection range.
- c. If no device found in some seconds, then the Bluetooth function will automatically turn into pairing mode.
- d. Now you can process for new mobile device pair. (refer to item E.1.d ~ E.1.f methods)

**Note:** BT-210 Light have about 30 seconds time waiting, for reconnect the previous paired device, at each time you turn On it Bluetooth function.

## **8. Switch to new pairing from connected mode**

- a. In Bluetooth connected mode, you can switch the Bluetooth function into Bluetooth searching mode for paring with the new device at any time you desired;
- b. Press and hold the **“⏮/▶ (14)”** button until a series of tones sound and the **“Bluetooth LED (6)”** will switch to rapidly flash blue from connected mode.
- c. Now you can process for new mobile device pair. (refer to item E.1.d ~ E.1.f methods)

## **9. Hand Free Function**

- a. When there is an incoming call during Bluetooth music playing mode;
- b. The ringing sound will up and the playing music will pause automatically.
- c. In this design, we recommended you to use your mobile device to reject or pick up the call for easy method. However, you also can;
- d. Press and hold **“⏮/▶ (14)”** button to reject the call if you want. Or,
- e. Press **“⏮/▶ (14)”** button to pick up the call.
- f. Now you have hand free function with the Bluetooth speaker.
- g. Press **“⏮/▶ (14)”** again to hang up the call when finished. And the

paused music will resume automatically.

**Tip:** speak to the “**MIC (9)**” direct with distance in 30 ~ 60cm to get the best speakerphone performance when necessary.

## 10. Redial For Last Call Function

- To redial for last called number by the Bluetooth function, even it is in music playing mode.
- Press twice the “**⏮/⏭ (14)**” button to enter into redial function, the playing will pause and switch to hand free function for redial.
- Press the “**⏮/⏭ (14)**” Button again to hang up the redial call.
- Make sure that your mobile phone has have last dial call used, if not, the redial for last call function cannot be activated.

## F. Use AUX IN Function

Please turn on the Bluetooth function when you want to use the AUX In function. And make sure that the external device has switched on and controlled to AUX output source with music playing.

- In power at on and Bluetooth function mode;
- Connect the Bluetooth Speaker’s “**AUX IN Jack (16)**” with an external device’s “**Earphone/AUX/LINE**” Output through the Audio Cable (Provided).
- The Bluetooth Speaker will switch to AUX In mode automatically from Bluetooth mode, a series of tones will sound and the “**Bluetooth LED (6)**” will switch to light **red** from blinking **blue**.
- At the same time, the RGB lights will switch to rainbow effect once AUX In is in connected mode.
- Now the AUX In function is ready, start to music play from your external device by it control and or program, for example, Play, Stop, volume control...etc.
- Besides, you also can use Bluetooth Speaker control;
- Press and hold the “**+ (11)**” button to increases the volume level.
- Press and hold the “**— (12)**” button to decreases the volume level.
- When maximum or minimum volume is reached, a beep will sound.
- Disconnect the Audio cable when it is done and it will switch back to Bluetooth mode automatically.

## G. Low Power Reminder And Auto Sleep

- The Bluetooth Speaker will send tones sound from speaker in minutes. When you heard this reminder sound, please connect the device with USB power for charge if you still want to use the device.

2. If not, the Bluetooth Speaker will power Off to sleep mode when the battery is keeping low energy level in some minutes.
3. In this case, the device cannot be turned On, until you recharging the battery at least 10 ~ 15 minutes, because the rechargeable battery has not enough energy.
4. To restart the device from sleep, slide the **“Power ON/OFF (10)”** switch to **“OFF”** position for 10 seconds and then slide it to **“ON”** position again.

## H. Use the BT-210 Light App:

Use this app to provide light, music, timing (alarm), Bluetooth connect functions for the BT-210 Light.

Follow these steps below to download the app on your Android device, iPad, iPhone or iPod touch:

### **Note:**

- *Ensure that your device has internet access via your service provider or wireless connection.*
- *Apple app supports device with iOS 8.0 or above and Android apk supports smartphone device with Android V4.3 or above.*

### **1. To download and install App:**

- a. Open the Apple App Store or Google Play Store on your mobile device.
- b. Search for app name **“Lenco BT-210”**.
- c. Follow the on-screen instructions to download and install the app.
- d. Once downloaded and installed, the BT-210 Light app will appear on your device’s home screen.
- e. Launch the app and you will see the below show interfaces when you choose them on app.
- f. Make sure that in **“Connect”** interface, you should see the **“BT-210 Light”** device show connected in Bluetooth list. If not, tap it for connecting or use the settings menu of your mobile device.

### **2. Clock Time Sync:**

- a. The device clock time will sync automatically when even time you open this mobile app and in Bluetooth connecting mode;
- b. In this mean, BT-210 LIGHT clock time will be adjusted the same automatically as the clock time of your mobile phone which in paired and used.

### 3. App interfaces:

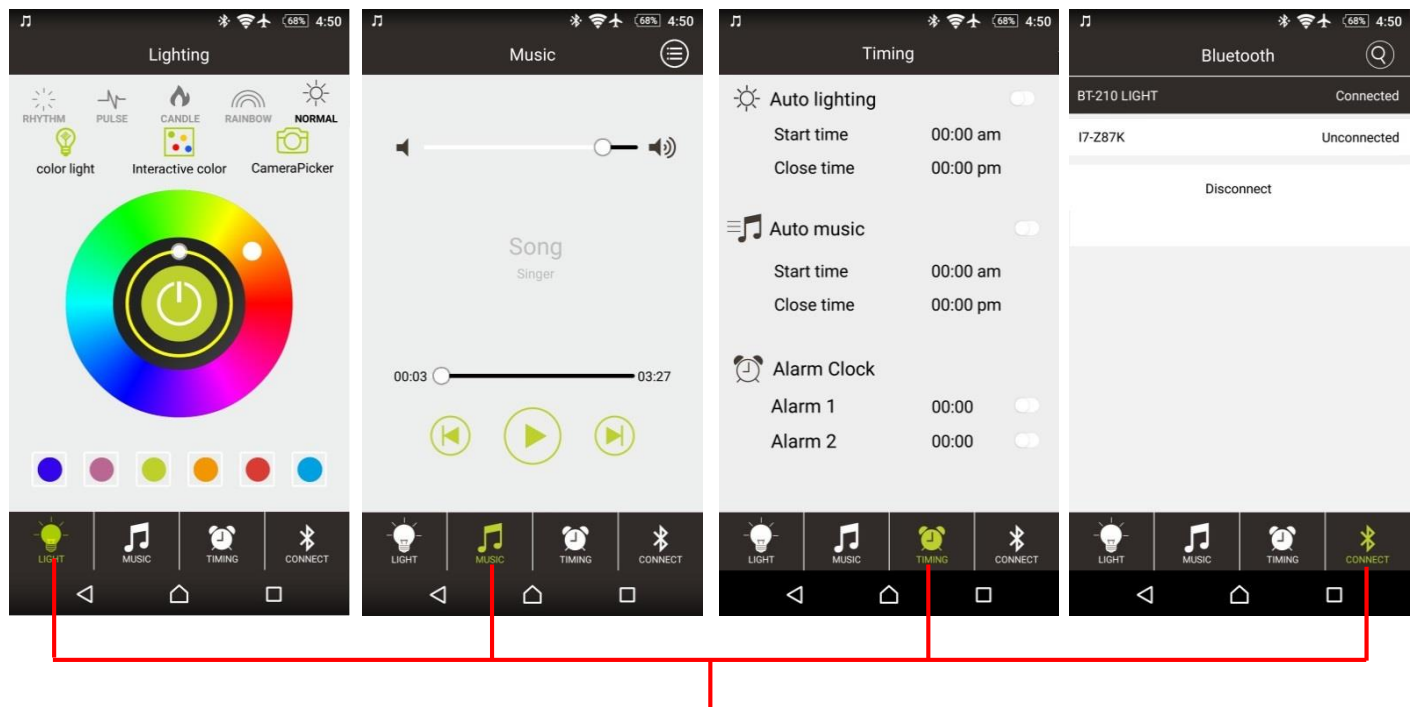

Interface Menus

### 4. Use light interface on app:

- In **"LIGHT"** interface, choose **"color light"** or **"white light"** mode as you desired to adjust;
- In color light mode, you can choose **"Normal/Rainbow/Candle/Pulse/Rhythm"** effect as you desired.
- Choose **Rhythm** to open the RGB music light effect, and then the RGB lights will change colors according to the rhythm of Bluetooth playing music.
- Choose **Normal** effect can make change whatever color you like by using the color spectral chart, or choose direct to color by using the color dot icons. Also, you can adjust the light level by using the circle icon in center area.

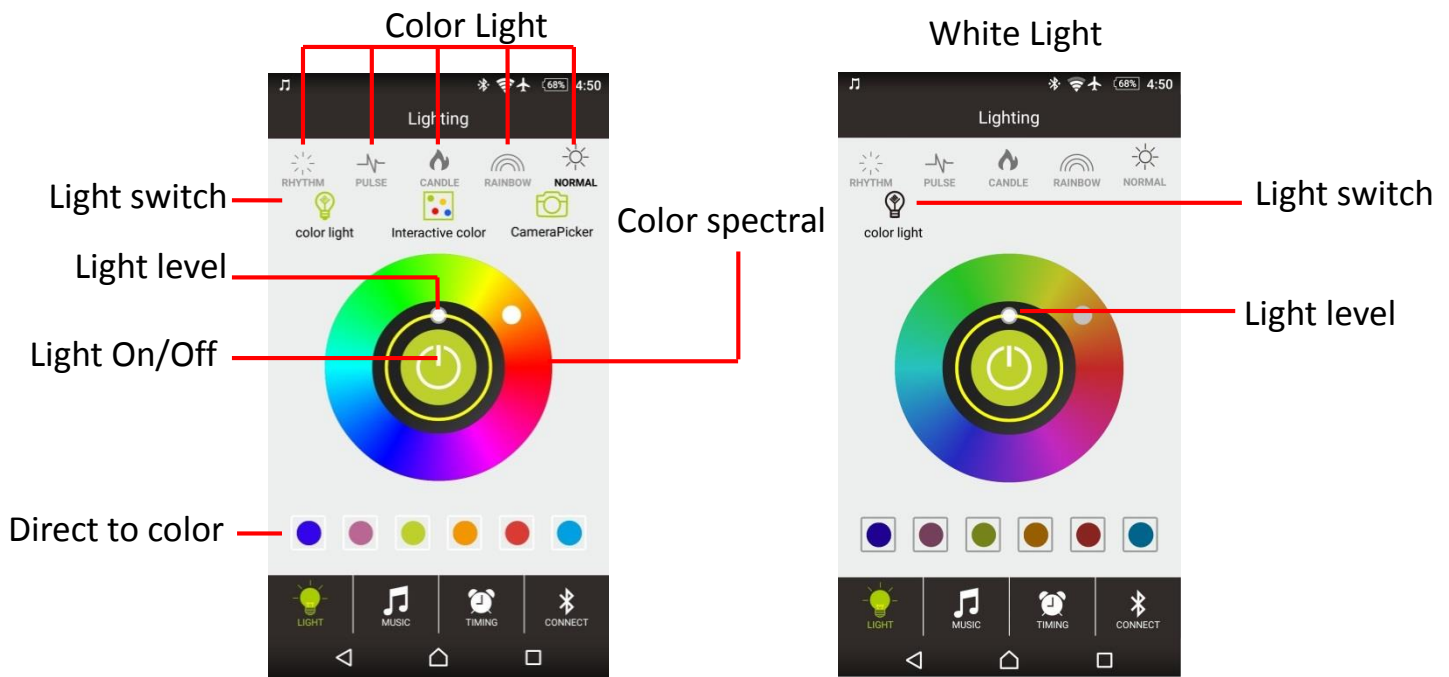

## 5. Use Game on app:

- In **"LIGHT"** interface, choose **"Color light"** > **"Normal"** > **"Interactive Color"** mode;
- The game interface appears and color dot rising from bottom to top for play;
- Tap the rising color by in order, and the device lighting color is changing according to what color you choose.
- This game may be good for training your eyes, brain and finger(s) reaction or bring you a little bit of fun.

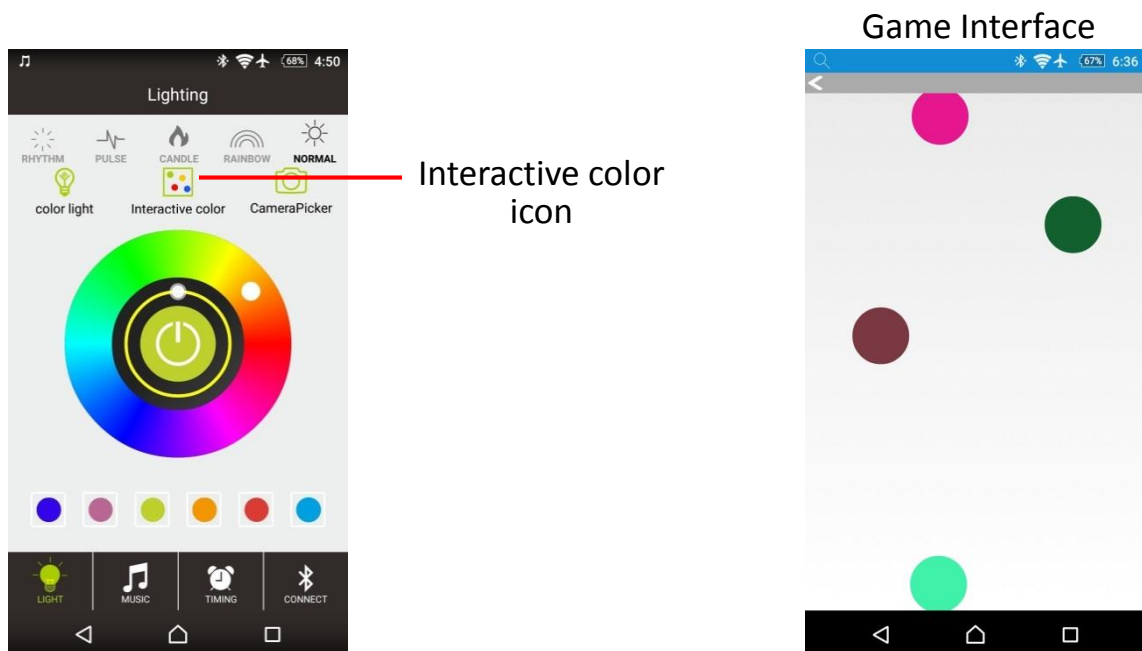

## 6. Use camera copy color interface on app:

- In **"LIGHT"** interface, you can choose **"Camera Picker"** functions to get the desired color from the object which pointing to;

- b. Tap **“Camera Picker”** icons for enter to color copy interface;

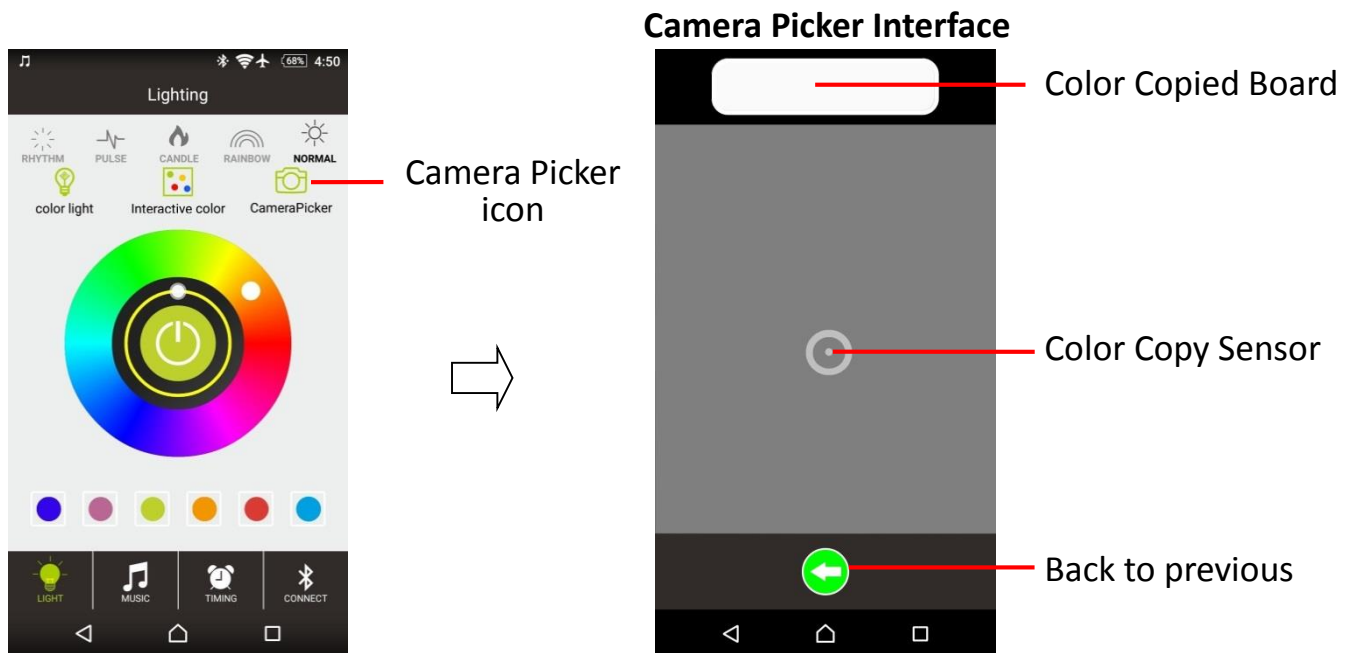

- c. Then, pointing the color copy sensor icon to desired color object, you will see the small circle icon change and show the target color according to the object colors;
- d. Once target color is confirmed, then tap the **“Color Copy Sensor”** icon or anywhere on camera screen to confirm;
- e. The wanted color will show in **“Color Copied Board”** and the device’s light will switch color to the wanted color at the same time.
- f. Repeat the above mentioned methods to copy another color that you want for device light color.

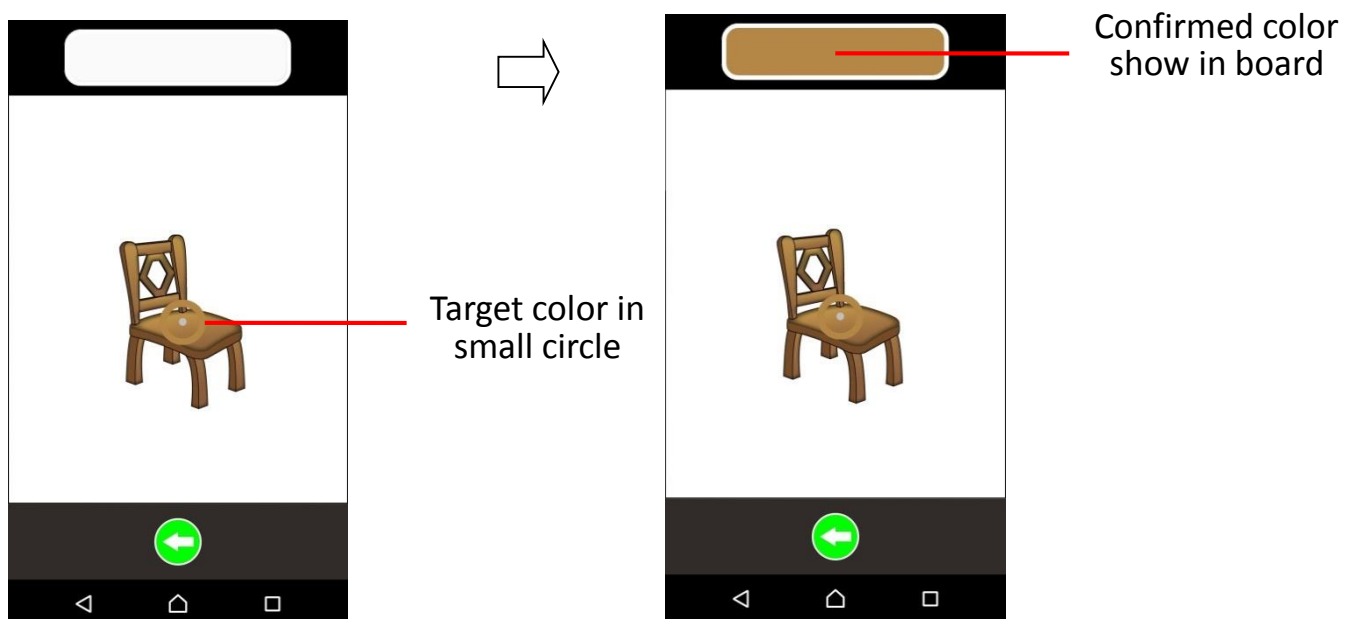

- g. Tap **“Back to previous”** icon to exit and back to light interface if you want.

**Note:** Some copied color show from device light tower will have different; it's due to some limitations of light tower plastic, as well as those RGB LED



bulbs. That is normal result for this device.

## 7. Use MUSIC interface on app:

- In **"MUSIC"** interface, you can control for play/pause, play next, play previous, adjust volume and select song file to play from playlist.
- Tap **"Playlist icon"** to enter device music list and select song for play.
- Tap or drag the related icons for enter to desired control functions when you want it.

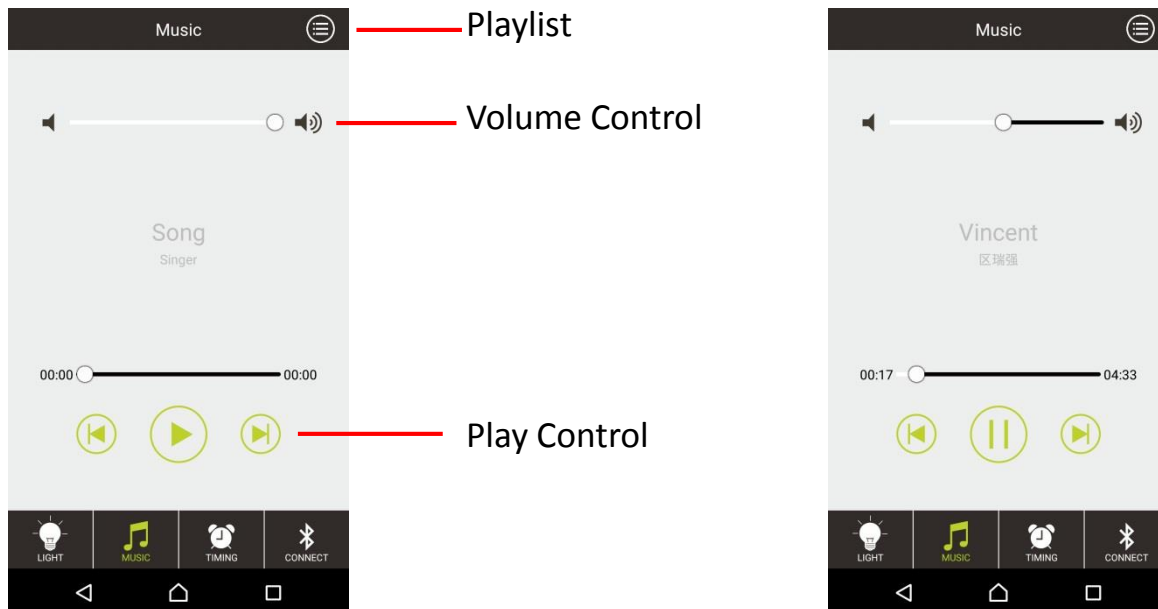

## 8. Use TIMING interface on app:

- In **"TIMING"** interface, you can choose and set for **"Auto lighting"**, **"Auto music"** and **"Alarm Clock"** functions as you desired;
- Tap and drag the related icons for enter to desired timing functions what you want to set;
- For example; Tap **"ON/OFF"** icon of **"Auto lighting"** to turn on this function, and then tap the **"Start time"** and **"Close time"** items, a time set dialog pop-up, to set you desired timer time to start and close the night light.
- Repeat the above mentioned methods to set the rest of timing functions if you want.

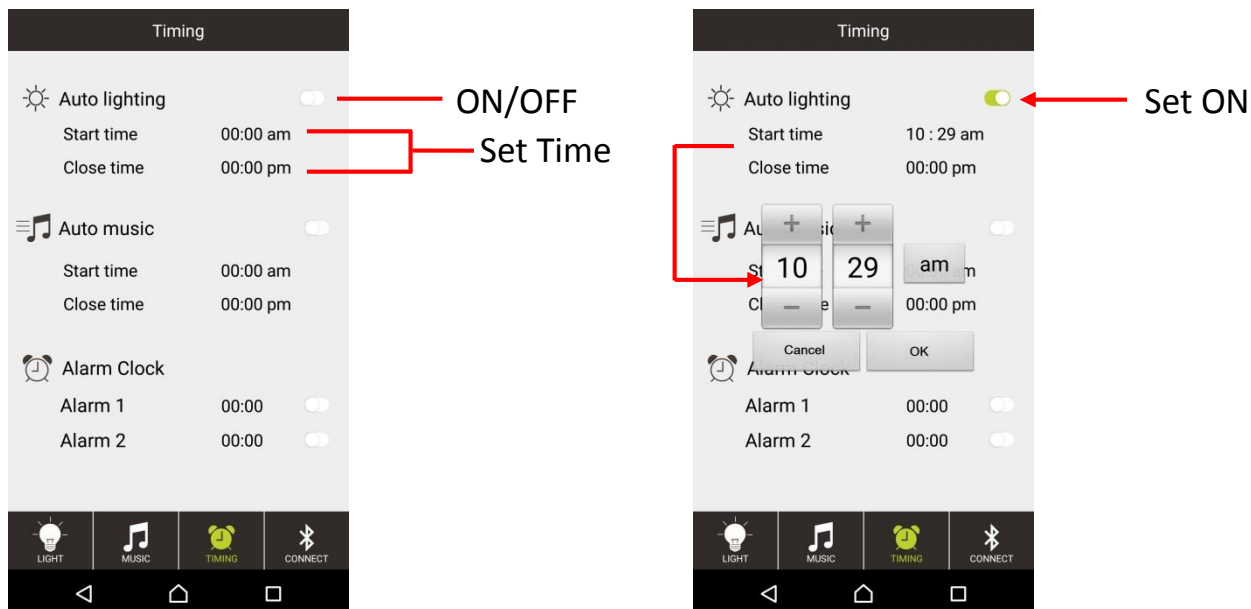

## 9. Alarm tone and turn off the alarm tone

- When Alarm Clock has set and time has come, the BT-210 LIGHT will sent tone sound of alarm each 8 seconds once, in 5 minutes, from speaker;
- To turn off the alarm ring, tap once the “☼ **Touch sensor (3)**” at right side on device handle. Or,
- Press any keys at back side of the device.

**Important:** Those changed and arranged settings in “**Timing**” menu will be activated only when the device and your mobile device are in Bluetooth connected mode. Please keep the BT-210 LIGHT and your mobile device Bluetooth function in connected mode if want them activated when you in sleeping.

## 10. Trouble Shooting

No power	<ul style="list-style-type: none"> <li>• Check battery is it charged with enough energy.</li> <li>• Check whether the device is in power OFF mode.</li> </ul>
No sound	<ul style="list-style-type: none"> <li>• Check whether volume level is in lower position on your Bluetooth speaker and mobile device.</li> <li>• Make sure that your Bluetooth device is within the effective operation range.</li> <li>• Check whether the Bluetooth device is paired.</li> <li>• Check whether the Bluetooth device show connected.</li> <li>• Check if you have selected the correct audio source.</li> </ul>
No response from speaker	<ul style="list-style-type: none"> <li>• Restart the device by power Off and On.</li> </ul>



## 11. Specification

Dimension	288 mm (L) x 113 mm (D) x 173 mm (H)	
Weight	832g (Approximate)	
Bluetooth	Specification	V4.0/V2.1 + EDR
	Supported Profile	A2DP, AVRCP, HSP, SPP
	Connection Distance	In 10 meters (open area)
Built-In Battery	Lithium 3.7V, 4000mAh	
	Playing Time: 6 ~ 8 Hours (at 75 ~ 80 % of volume setting)	
Power Source Input	Micro USB Port	
	DC 5V, 1A/1000mA	
Audio	Output Power	3W (RMS) x 2 (4 Ohm)
	Freq. Responses:	
	AUX In Bluetooth	80Hz ~ 20KHz 80Hz ~ 16KHz
I/O	Audio In Link	800mV RMS, 10K Ohm
Clock	LED display	For 24 hours display
Light Source	White LEDs	
	RGB LEDs	
Operating Temperature	0 to 40°C	

## 12. Disclaimer

Updates to Firmware and/or hardware components are made regularly. Therefore some of the instruction, specifications and pictures in this documentation may differ slightly from your particular situation. All items described in this guide for illustration purposes only and may not apply to particular situation. No legal right or entitlements may be obtained from the description made in this manual.

## 13. Service and Support

Lenco offers service and warranty in accordance to European law, which means that in case of repairs (both during and after the warranty period) you should contact your local dealer.

**Important note:** It is not possible to send products that need repairs to Lenco directly.

**Important note:** If this unit is opened or accessed by a non-official service center in any way, the warranty expires.

This device is not suitable for professional use. In case of professional use, all warranty obligations of the manufacturer will be voided.

## 14. Recycling

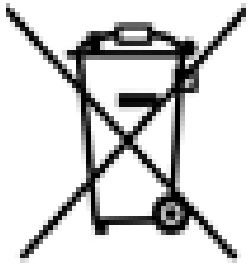

This symbol indicates that the relevant electrical product or battery should not be disposed of as general household waste in Europe. To ensure the correct waste treatment of the product and battery, please dispose them in accordance to any applicable local laws of requirement for disposal of electrical equipment or batteries. In so doing, you will help to conserve natural resources and improve standards of environmental protection in treatment and disposal of electrical waste (Waste Electrical and Electronic Equipment Directive).

## 15. CE Marking



Products with the CE marking comply with the EMC Directive (2014/30/EU) and the Low Voltage Directive (2014/35/EU) issued by the Commission of the European Community.

Hereby, Lenco Benelux BV Thermiekstraat 1A 6361HB Nuth (NL), declares that this product is in compliance with the essential requirements and other relevant provisions of Directive 1999/5/EC.

The declaration of conformity may be consulted at

<https://lencosupport.zendesk.com/forums/22413161-CE-Documents>

This product operates at 2400 - 2483.5 MHz and is designated only to be used inside a normal household environment. This product is suited for this purpose within all EU counties.

®All rights reserved