

# User's manual



Weather station with wireless outdoor sensor

# Alecto® WS-2300

## Overview:

### Indoor unit:

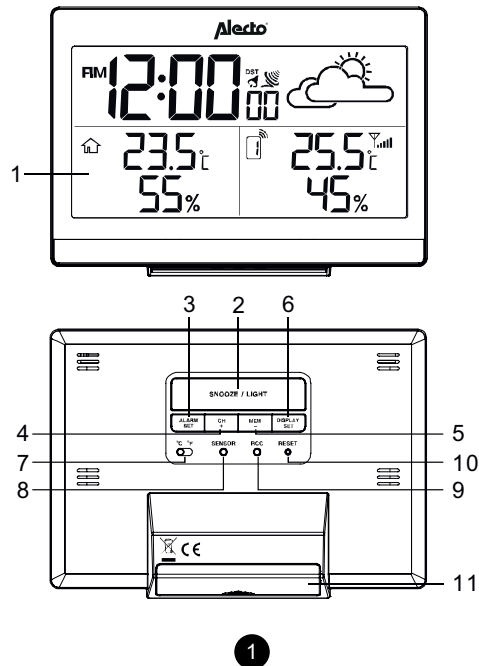

1

- Display:**  
Shows time, indoor and outdoor temperature and weather forecast.
- SNOOZE / LIGHT** button :  
Snooze button for the alarm function. Also turns on the display lighting.
- ALARM SET** button :  
For checking and setting the wake-up alarm.
- CH/+** button:  
Selection button when using multiple outdoor units and the '+' button during setup.
- MEM/-** button:  
Memory button when checking min and max values and the '-' button during setup.
- DISPLAY SET** button:  
Function setup button.
- °C / °F** switch:  
To switch the temperature display between degrees Celsius and degrees Fahrenheit.
- SENSOR** button:  
To pair the indoor unit with the outdoor unit.
- RCC** button:  
To turn the DCF receiver on or off.
- RESET** button:  
To restart the indoor unit in case of a (possible) error.
- Battery compartment.

### Outdoor unit:

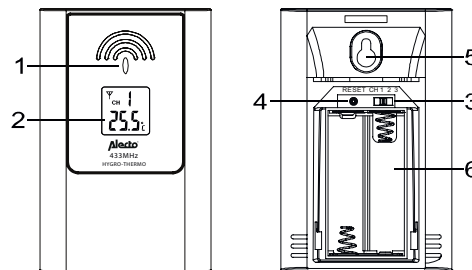

- Monitor-LED:** Illuminates as soon as the outdoor unit is sending measurement data to the indoor unit.
- Display,** shows alternately the temperature and the humidity.
- CH 1.2.3** switch:  
To set the outdoor unit to a different channel.

2

- RESET** button: To restart the outdoor unit in case of a (possible) error.
- Suspension eye: Provision to suspend the outdoor unit from a wall.
- Battery compartment.

## Power supply:

### Indoor unit:

Slide down the battery cover at the rear of the unit and insert 2 AA 1.5V batteries according to the markings inside the battery compartment. Slide the battery cover back onto the indoor unit. The indoor unit will now start a 1 minute scan to search for the outdoor unit. Therefore, you'll need to insert the batteries into the outdoor unit within that minute.

### Outdoor unit:

Slide down the battery cover at the rear of the unit, slide the CH switch to the position '1' and insert 2 AA 1.5V batteries according to the markings inside the battery compartment. Slide the battery cover back onto the outdoor unit.

### Weak battery warning:

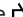
As soon as the batteries of the outdoor unit become exhausted, the  symbol will illuminate on the display of the indoor unit. Now please replace the batteries of the outdoor unit.

The indoor unit does not provide a battery warning. Replace the batteries of this unit as soon as the display becomes dim or weak.

## Pairing the indoor unit / outdoor unit:

### Automatically:

As soon as you insert the batteries into the indoor unit, the indoor unit will start a 1 minute scan to search for the signal of the outdoor unit. Therefore, if you insert the batteries into the outdoor unit within that minute and the units will 'find' each other, they will be automatically paired and the display of the indoor unit will show the temperature transmitted by the outdoor unit.

### Manually:

If the units cannot be paired automatically, or after replacing the batteries, you can pair the outdoor unit (again) with the indoor unit as follows:

- use a sharp object to briefly press the **RESET** button on the rear of the indoor unit
- use a sharp object to briefly press the **RESET** button on the rear of the outdoor unit
- the units will find each other (again) after several seconds and the indoor unit will display the temperature transmitted by the outdoor unit.

3

## Clock:

### Introduction

The WS-2300 is provided with a built-in DCF receiver which receives the DCF time signal from Frankfurt. This signal ensures that the clock shows the time very accurately, provided a strong enough signal is being received.

### Automatically:

As soon as you insert the batteries into the indoor unit, the clock will start searching for the DCF radio signal for the time while the  antenna symbol is flashing. After several seconds or minutes the WS-2300 will start showing the correct time. In extreme cases, it can take over a day before the DCF time is shown.

### Manually:

If the clock cannot receive the radio signal or cannot receive it well enough, you can set the clock manually as follows:

- press and hold the **DISPLAY SET** button for 2 seconds, 12Hr or 24Hr will appear in the display
- use +/- to set the time format, then briefly press the **DISPLAY SET** button
- use +/- to set the hours and then briefly press the **DISPLAY SET** button
- use +/- to set the minutes and then briefly press the **DISPLAY SET** button
- use +/- to set the seconds to 0 (this allows you to have the clock run synchronously with your own clock) and then briefly press the **DISPLAY SET** button
- use +/- to set the hour difference compared to the DCF time. E.g. for use in the Benelux select '0' and then briefly press the **DISPLAY SET** button

The clock is now set manually.

When the DCF receiver is enabled and a strong signal is being received, the receiver will overwrite the clock display.

### Switching the DCF receiver on/off:

You can turn off the DCF receiver as follows, allowing you to have only the time and date shown on the display according to your programming:

- turn off: press and hold the **RCC** button at the rear of the indoor unit for 4 seconds until the  antenna symbol disappears.

You can turn the receiver back on as follows:

- turn on: briefly press the **RCC** button at the rear of the indoor unit until the  antenna symbol starts flashing

### 'DST' in the display.

'DST' stands for Daylight Saving Time. 'DST' illuminates when the displayed time is the daylight saving time.

4

## Alarm

### Setting & turning on the wake-up alarm:

1. press and hold the **ALARM SET** button for 2 seconds
2. use +/- to set the hours and briefly press the **ALARM SET** button
3. use +/- to set the minutes and briefly press the **ALARM SET** button, the alarm time is now saved (and is also activated immediately)

### Switching on/off:

Briefly press 2x the **ALARM SET** button. When the wake-up alarm is currently enabled, "🔔" will be shown; if "🔔" is not illuminated, the alarm is disabled.

### Operation:

- As soon as the set time is reached, the alarm will sound for up to 120 seconds.
- Press the **ALARM SET** button to stop the alarm signal earlier or press the **SNOOZE/ LIGHT** button to enable the snooze function; the wake-up alarm will then sound again after 5 minutes.
- The alarm is repeated daily.

## Temperature display

Use the °C / °F switch at the rear of the indoor unit to display the temperature in degrees Celsius or in degrees Fahrenheit.

The 🏠 symbol is followed by the indoor temperature. Behind 🏠 that the outdoor unit is shown from outdoor unit 1.

Use the **CH** button at the rear of the indoor unit to display the temperature from outdoor unit 2 or 3 or press and hold the **CH** for 2 seconds to automatically start scrolling through all channels. Briefly press the **CH** button to stop this scan. See also chapter 'Expansion'.

### Max/min temperature:

Briefly press the **MEM** button to check the maximum temperature measured, press the **MEM** button again for the minimum temperature.

Press and hold the **MEM** button for 3 seconds to delete the MAX and MIN values. Also after replacing the batteries of pressing the **RESET** button, the MAX and MIN values are deleted.

### Ice alarm:

As soon as the outdoor temperature falls within a range of +3°C and -2°C, the ❄️ symbol starts flashing in the display.

## Weather forecast:

The WS-2200 can predict the weather for the following 12 to 24 hours based on the changes in air pressure and shows this forecast using the following icons:

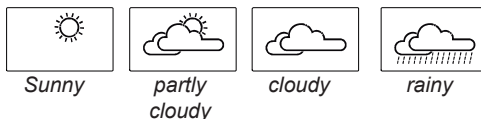

### Remarks:

- the accuracy of a forecast based on air pressure is 70% to 75%; please keep in mind that a correct display of the weather forecast is not guaranteed.
- the prediction is based on the coming 12 to 24 hours and does not necessarily represent the current weather conditions.
- the 'Sunny' forecast shown at night means an open weather type.
- the 'Rainy' prediction during winter, usually means snow.

## Expansion:

You can register up to 3 outdoor units to the indoor unit to have the temperature measured at 3 different locations (e.g. in your greenhouse, pet room, different bedrooms, etc.). You can order additional outdoor units via the internet at [www.alecto.nl](http://www.alecto.nl)

### Registering additional outdoor units:

1. slide down the battery cover at the rear of the new outdoor unit and insert 2 AA 1.5V batteries according to the markings inside the battery compartment.
2. just above the batteries at the rear of the outdoor unit, slide the 'CH' channel switch to position 2 or position 3.
3. slide the battery cover back onto the outdoor unit.
4. now repeatedly and briefly press the **CH** at the rear of the indoor unit until 🏠<sup>1</sup> or 🏠<sup>2</sup> illuminates (depending on whether you've selected 'CH-2' or 'CH-3' in the outdoor unit) and then briefly press the **SENSOR** button.
5. the indoor unit will now start searching for the outdoor unit and as soon as the units find each other, the temperature will be shown on the display of the indoor unit.

## Reset/System error:

If the WS-2300 shows a possible error, you may have to reset the indoor and outdoor unit.

1. use a sharp object to press the reset button at the rear of the indoor unit.
2. use a sharp object to press the reset button at the rear of the outdoor unit (for this, you'll need to briefly remove the battery cover from the outdoor unit).

The indoor and outdoor units will then be reset and a new pairing scan will start. After several seconds, you can continue using the WS-2300.

If you still have no connection or sound, please contact the customer service of Alecto via internet [www.alecto.nl](http://www.alecto.nl)

## Specifications:

### Indoor unit:

measurement range: -40°C ~ 70°C (-40°F ~ 158°F)  
recommended operating temperature:  
0°C ~ 45°C (32°F ~ 113°F)  
resolution: 0.1°C / 0.1°F  
DCF receiver: DCF-77  
power supply: 2x 1.5V battery, size AA  
battery lifespan: 1 year  
dimensions: 140(W)x100(H)x47(D)mm  
weight: 213g (batt incl.)  
amount of outdoor units to register: max 3

### Outdoor unit:

measurement range: -40°C ~ 70°C (-40°F ~ 158°F)  
recommended operating temperature:  
-20°C ~ 55°C (-4°F ~ 131°F)  
resolution: 0.1°C / 0.1°F  
power supply: 2x 1.5V battery, size AA (\*)  
battery lifespan: 1 year  
dimensions: 65(W)x100(H)x35(D)mm  
weight: 75g (batt incl.)

\*: for long-term use at temperatures below 0°C, we recommend using Lithium batteries which you can order via the Alecto customer service at phone number 073 6411 355 (Netherlands) or 03 238 5666 (Belgium) or via the internet at [www.alecto.nl](http://www.alecto.nl).

### Radio:

transmission frequency: 433MHz  
Maximum Power : < 0 dBm  
channels: 3  
reception interval: 60-64sec.  
range: up to 50m

## Symbol 🏠:

Only 🏠 illuminates: no outdoor unit is registered on this channel.  
🏠 flashing: the indoor unit is searching for the outdoor unit.  
🏠 remains lit: the indoor unit is connected to the outdoor unit

## Declaration of conformity

Hereby, Hesdo declares that the radio equipment type Alecto WS-2300 is in compliance with directive 2014/53/EU. The full text of the EU declaration of conformity is available at the following internet address:  
<http://DOC.hesdo.com/WS-2300-DOC.pdf>

## Environment:

At the end of its lifespan, this product should not be discarded as normal domestic waste, but is must be taken to a collection point for the recycling of electric and electronic equipment.



Don't throw away exhausted batteries, take them to your local depot for small chemical waste.

## Location outdoor unit:

It is advised to not mount the outdoor-unit direct in rain or snow. Please look for a more covered place.

**Alecto**<sup>®</sup>

Service 🔧↓Help 🧑‍🔧?

HSC**WWW.ALECTO.NL**  
**SERVICE@ALECTO.NL**

**Hesdo, Australiëlaan 1**  
**5232 BB, 's-Hertogenbosch**  
**The Netherlands**